

Xiaomi Electric Shaver S301 User Manual



Safety Instructions

- Keep the appliance dry.
- Detach the hand-held part from the supply cord before cleaning it in water
- This appliance is not intended for use by persons (including children) with reduced physical sensory or mental capabilities or lack of experience and knowledge, unless they have been given supervision or instruction concerning use of the appliance by a person responsible for their safety.
- Children should be supervised to ensure that they do not play with the appliance.
- Use only with <A520-050100U-EU1> supply unit.
- This appliance contains a battery that is non-replaceable.
- **WARNING:** For the purposes of recharging the battery, only use the detachable supply unit provided with this appliance.
- The plug must be removed from the socket-outlet before cleaning or maintaining the appliance.
- Appliance can be used by children aged from 8 years and above and persons with reduced physical, sensory or mental capabilities or lack of experience and knowledge if they have been given supervision or instruction concerning use of the appliance in a safe way and understand the hazards involved.

CAUTIONS

- Cleaning and user maintenance shall not be made by children without supervision.
- Do not charge this shaver in humid environments.
- Do not disassemble the body to replace the battery.
- Do not modify or repair this shaver yourself.
- The appliance is not suitable for use in a bath or shower.
- Do not expose the appliance or battery to excessive temperatures.
- Be aware of the risk of terminals of the battery-operated appliance or battery being short circuited metal objects.



Suitable for cleaning under an open water tap

A520-050100U-EU1



Use only with <A520-050100U-EU1> supply unit.



Read operator's manual.

Product Overview

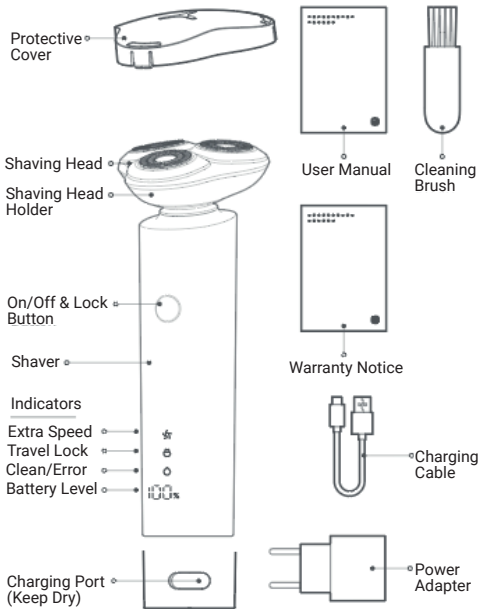

Note: Illustrations of product, accessories, and user interface in the user manual are for reference purposes only. Actual product and functions may vary due to product enhancements.

How to Use

Notes:

- It is normal that the skin is slightly irritated after the first few shaves. It is recommended to regularly use the shaver (at least 3 times a week) for 3 weeks to allow the skin to adapt as quickly as possible.
- Improper use of this shaver can easily cause damage to blade meshes and shaving head. Please check whether the blade meshes and shaving head are intact before use. Immediately stop using the shaver if any damage is found.

Turning on/off:

- Turning on/off: Press the on/off button.
- Once the shaver is turned on, the clean/error, travel lock, and extra speed indicators will turn on and off in sequence, and the extra speed indicator will light up again or remain off according to the speed settings enabled. The battery level indicator will show the current battery level. Once the shaver is turned off, all indicators will go off.

Adjusting the speed settings:

- The first time the shaver is turned on, by default it is set to smart speed. The next time it is turned on, by default the speed settings will be the same as it was last time the shaver was turned off.
- While the shaver is turned on, press and hold the on/off button for 1 second to switch the speed settings between extra speed (extra speed indicator is on) and smart speed (extra speed indicator is off).
- Smart speed: Once selected, the shaver usually works at the normal rotation speed. When the working load on the motor increases, the shaver will automatically increase the rotation speed and maintain a high rotation speed for 10 seconds.
- Extra speed: Once selected, the shaver will maintain a high rotation speed throughout the shave. This is good for shaving dense beard quickly.



Note:

Apply gentle pressure and shave your face slowly in circular motions. It is not necessary to repeatedly shave the same area to achieve a clean shave. Shave dry for an optimal result.

Travel Lock

This shaver is equipped with a travel lock to prevent it from accidentally being turned on while it is inside the luggage.

- Enabling the travel lock: When the shaver is turned off, press and hold the on/off button for 2,5 seconds until the motor stops to enable the travel lock. Once it is enabled, the travel lock indicator will blink for 3 seconds and then go off.
- Disabling the travel lock: Press and hold the on/off button for 2,5 seconds. The travel lock indicator will blink for 3 seconds and then go off, and the motor will run, indicating that the travel lock is disabled.

Note: When the travel lock is enabled, if you press the on/off button, the travel lock indicator will blink, but the motor will not be activated.

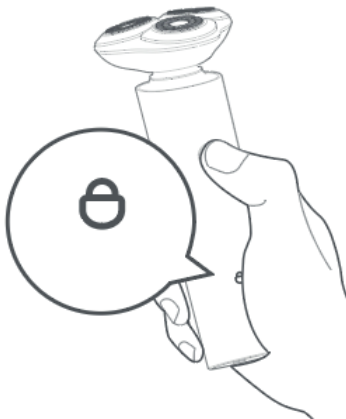

Battery Level Indication

To charge the shaver, connect the USB end of the charging cable to the charger and the Type-C end to the charging port of the shaver. While charging the battery level indicator will breathe and the number will increase. Once the shaver is fully charged, the battery level indicator will remain at 100 %.

	Battery Level	Indicator Status
Operating	6 % - 100 %	Keeping on
	≤ 5 %	Blinking
	0 %	Unable to turn on
Charging	0 % - 99 %	Breathing
	100 %	Keeping on

When the shaver cannot be turned on due to a low battery, it will take about 2 hours to fully charge it. The shaver can be used for about 1,5 hours after a full charge. Please charge the shaver when its battery is low. Fully charge the shaver at least once every 6 months if it will not be used for an extended period of time.

Note: The shaver supports plug-and-play. When the battery is low, you can use the shaver during charging.

CAUTION: Never plug in or use the shaver in the shower or when the charging port is wet.

Cleaning & Maintenance

If the clean/error indicator blinks for 5 seconds and then goes off while the battery level indicator is on after the shaver is turned on, please clean the shaver. The clean/error indicator will automatically blink for 5 seconds once every 15 minutes of use to remind the user to regularly clean stubble buildup from the shaver.

1. Make sure the shaver is turned off and is not being charged before cleaning it.



2. Rinse the shaving head under a faucet (warm water is recommended).



3. Pull the shaving head and remove it from the holder.



4. Rinse or use the cleaning brush to clean the shaving head holder.



5. Turn the shaving head upside-down and clean the inside of the shaving head under a faucet. Warm water is recommended. Do not use a towel or paper towel to clean the shaving head.



6. Thoroughly dry off the shaver, then install the shaving head back onto the holder.



Note: Use the protective cover to cover the charging port while cleaning the shaver. Make sure the charging port is dry when plugging in the cable to charge.



The shaver can be cleaned under faucet. To Keep the charging porty dry, make sure it is firmly covered.

Note: To ensure the performance of the shaver, it is recommended to replace the shaving head once every 2 years. Please go to www.mi.com to purchase a replacement.

Environmental Protection

When the shaver reaches the end of its service life, please remove, dispose of, or recycle the built-in battery in accordance with local laws and regulations of the country or region where the shaver is used. If the battery cannot be removed, dispose of it in strict accordance with local regulations on household waste management in your area.

WARNINGS:

- Do not expose the battery to fire to prevent it from exploding or releasing toxic and hazardous substances.
- Do not short-circuit the battery to prevent it from combusting and causing fire.
- Do not disassemble the shaver unless you want to dispose of it; otherwise, the shaver will be damaged.
- Make sure to operate in a safe manner and unplug the shaver before removing the battery.
- The battery must be removed from the appliance before it is scrapped.
- The appliance must be disconnected from the supply mains when removing the battery.
- The battery is to be disposed of safely.

Troubleshooting

Issues	Causes	Solutions
The shaving quality is poor.	The shaving head is damaged or worn out.	Replace with genuine shaving head.
	The shaving head is clogged up with stubble.	Thoroughly clean the shaving head.
	The battery is low or depleted.	Connect the charging cable to charge.
The shaver does not work after pressing the on/off button.	The on/off button does not function.	Contact the after-sales service team.
	The travel lock is enabled.	Press and hold the on/off button for 2,5 seconds to unlock.
The indicators do not work normally or do not light up.	The shaver needs to be charged due to low battery.	Charge the shaver.
	The circuit board is damaged.	Contact the after-sales service team.
The skin is irritated after shaving.	The shaving head is damaged or worn out.	Replace with genuine shaving head.
	It takes a certain period of time for your skin to adapt to the shaver.	The skin irritation will fade after 2-3 weeks of use.
The shaver does not charge.	The shaver is damaged .	Contact the after-sales service team.
	The charging ambient temperature is too low or too high.	Charge in an ambient temperature between 5 °C and 35 °C.
The usage time is less than 60 minutes after being fully charged.	The load on the motor is increased as the shaving head hasn't been cleaned for a long time.	Thoroughly clean the shaving head.
	There is an issue with the shaver battery.	Contact the after-sales service team.
The clean/error indicator blinks for 5 seconds after turning on the shaver.	The shaving head hasn't been cleaned for a long time.	Thoroughly clean the shaving head.
	The shaving head is not properly installed.	Reinstall the shaving head.

Specifications

Name: Xiaomi Electric Shaver S301	
Model: S301	Charging Port: Type-C
Operating Voltage: 3,7 V \approx	Input: 5 V \approx 1A
Operating Power: 3 W	Charging Time: Approx. 2h
IP Rating: IPX7	

Power Adapter

Input: 100-240 V \sim , 50/60 Hz, 0.2 A		Output: 5.0 V \approx 1.0 A, 5.0 W
Information Published	Value and Precision	Unit
Manufacturer's Name	Jiangxi Jian Aohai Technology Co., Ltd.	—
Model Identifier	A520-050100U-EU1	—
Input Voltage	100-240	V \sim
Input AC Frequency	50/60	Hz
Output Voltage	5.0	V \approx
Output Current	1.0	A
Output Power	5.0	W
Average Active Efficiency	73,77	%
Efficiency at Low Load (10 %)	64,588	%
No-load Power Consumption	0,075	W





Europe-EU Declaration of Conformity

We, Shenzhen Soocas Technology Co., Ltd. hereby, declares that this equipment is in compliance with the applicable Directives and European Norms, and amendments. The full text of the EU declaration of conformity is available at the following internet address:

<http://www.mi.com/global/service/support/declaration.html>



WEEE Disposal and Recycling Information

All products bearing this symbol are waste electrical and electronic equipment (WEEE as in directive 2012/19/EU) which should not be mixed with unsorted household waste. Instead, you should protect human health and the environment by handing over your waste equipment to a designated collection point for the recycling of waste electrical and electronic equipment, appointed by the government or local authorities. Correct disposal and recycling will help prevent potential negative consequences to the environment and human health. Please contact the installer or local authorities for more information about the location as well as terms and conditions of such collection points.

Importer:

Beryko s.r.o.

Pod Vinicemi 931/2, 301 00 Plzeň

www.beryko.cz



Manufactured for: Xiaomi Communications Co., Ltd

Manufactured by: Shenzhen Soocas Technology Co., Ltd.

(a Mi Ecosystem company)

Address: Room 401, 402, 1101, 1102, 1103, 1104, Building 2 Chongwen Area, Nanshan iPark, No. 3370 Liuxian Avenue, Fuguang Community, Taoyuan Subdistrict, Nanshan District, Shenzhen, China

For further information, please go to www.mi.com

Made in China

User Manual Version: V1.0